

Chatterbox Creatures



Using an old playground favourite “chatterboxes” we can craft them into creatures to play with!

Tools and Materials:

- Coloured Paper
- Pencil
- Glue Stick
- Scissors



Because the majority of paper we have at home is rectangular (A4) we need to make it square first - take the paper and fold one of the corners over to the opposite side to make a triangle like so

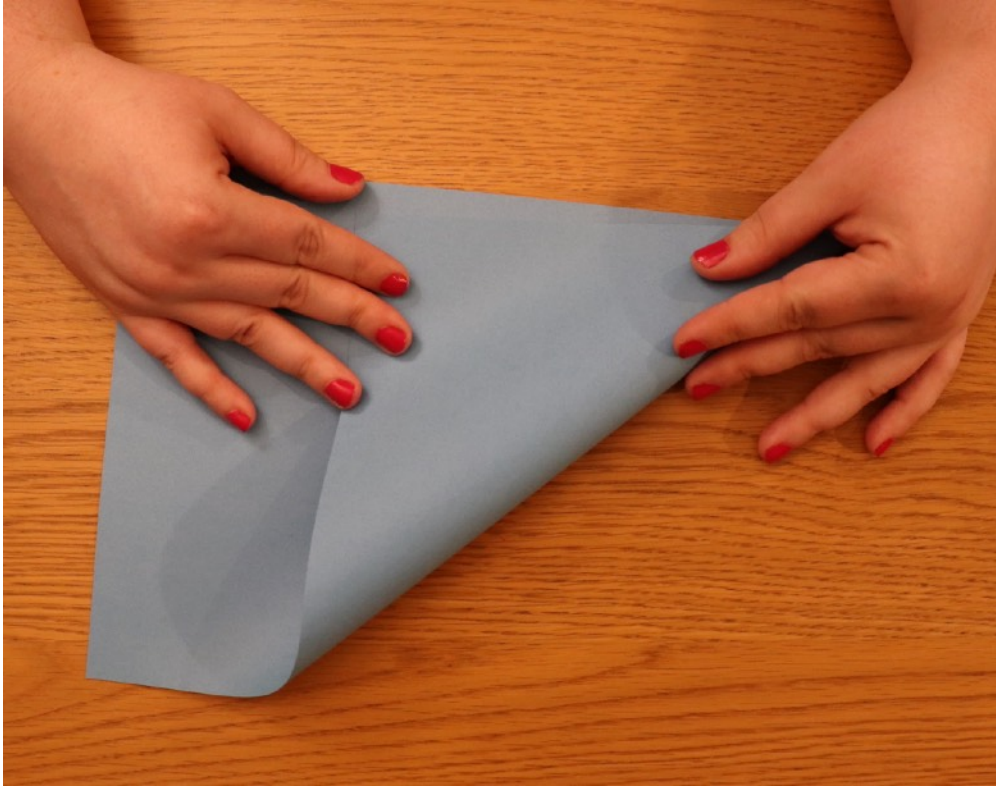

Press down on the fold hard to make a firm line to make the triangle and then cut off the excess paper as below

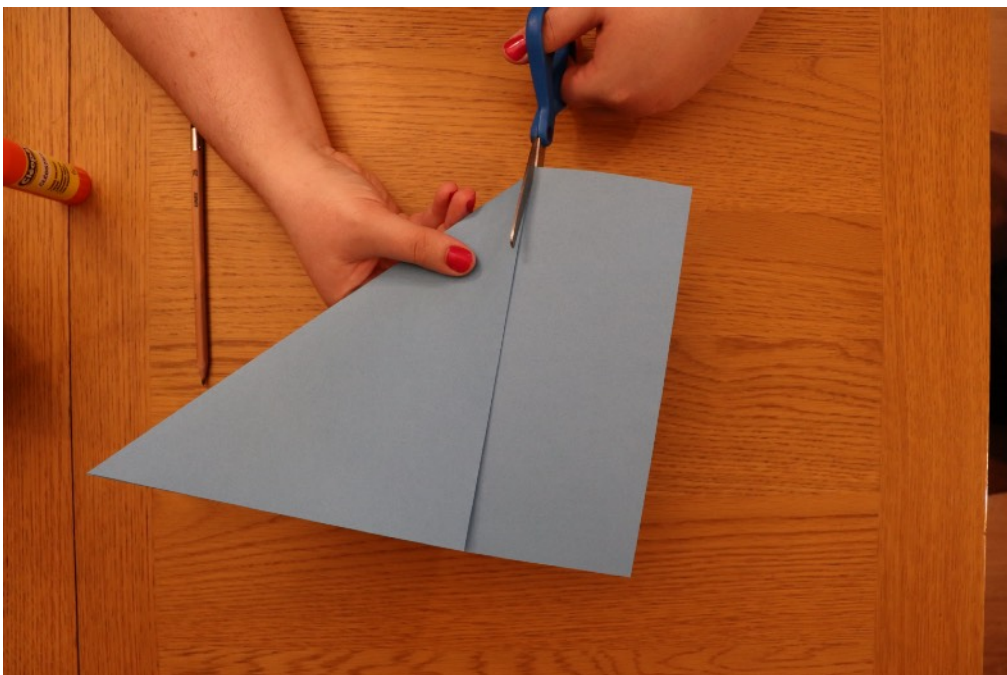

Open up your triangle to create the square and then once open fold it in half to form a rectangle shape, open it back to the square and fold in half the other way so your paper looks like it is divided into square quarters

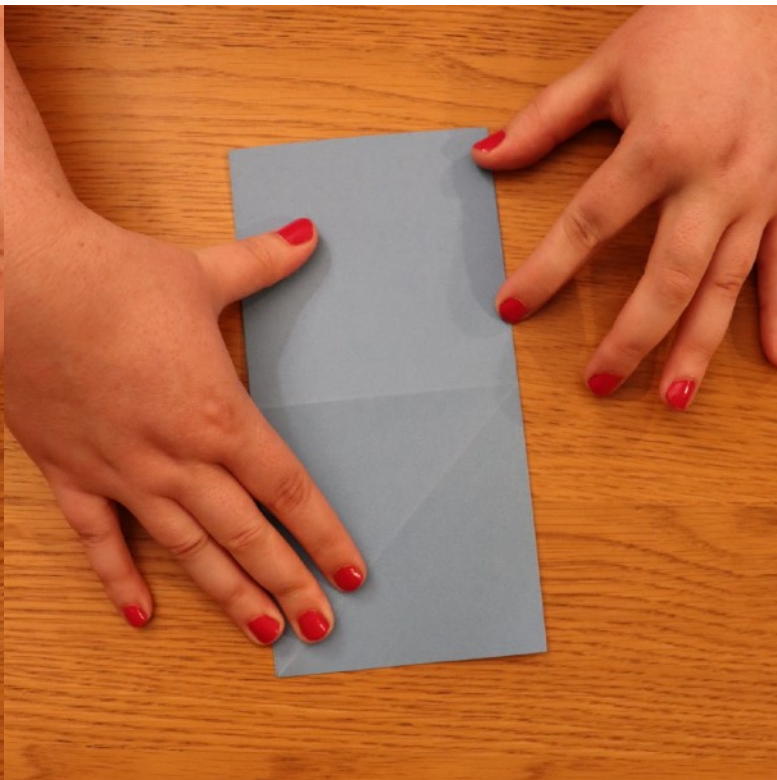
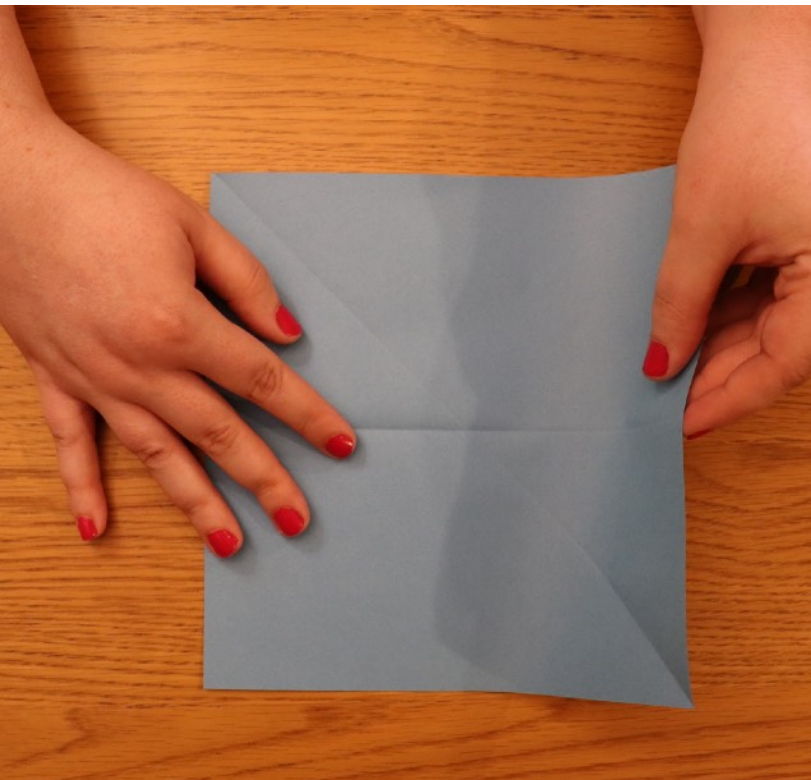
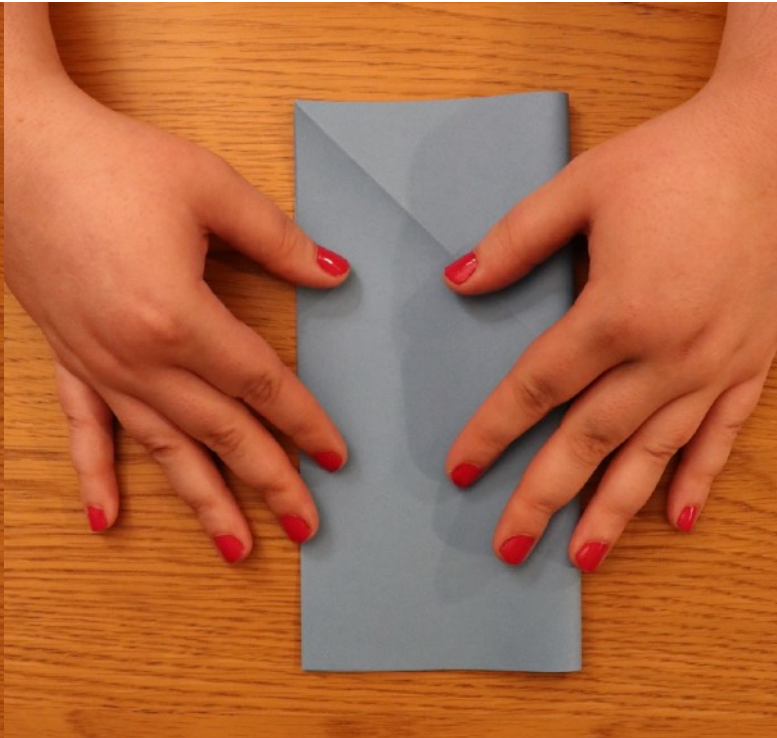
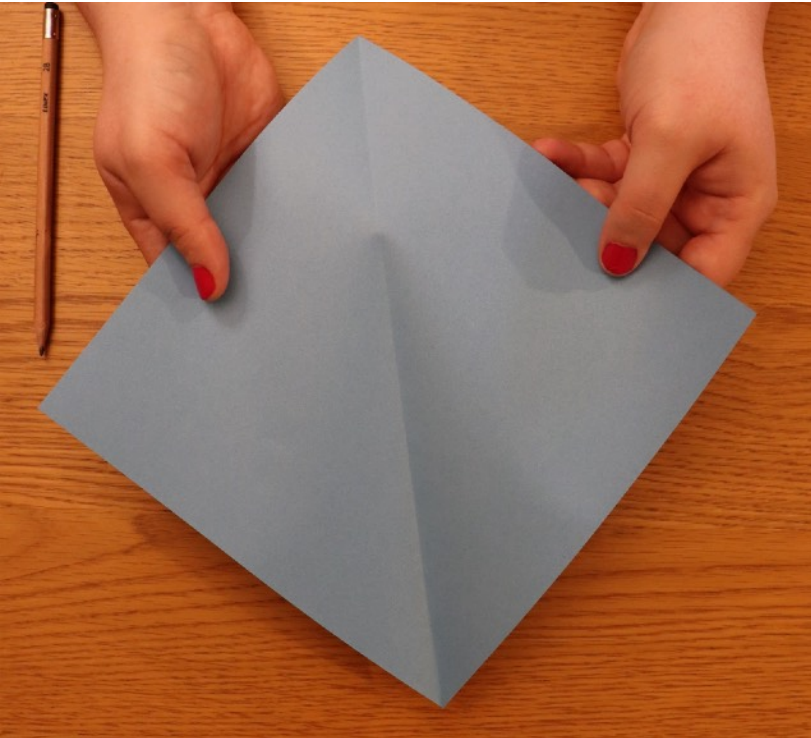

Using the cross lines created fold each of the 4 corners into the middle like so - make sure you push down the fold lines hard, it can be helpful to use your nail or a ruler

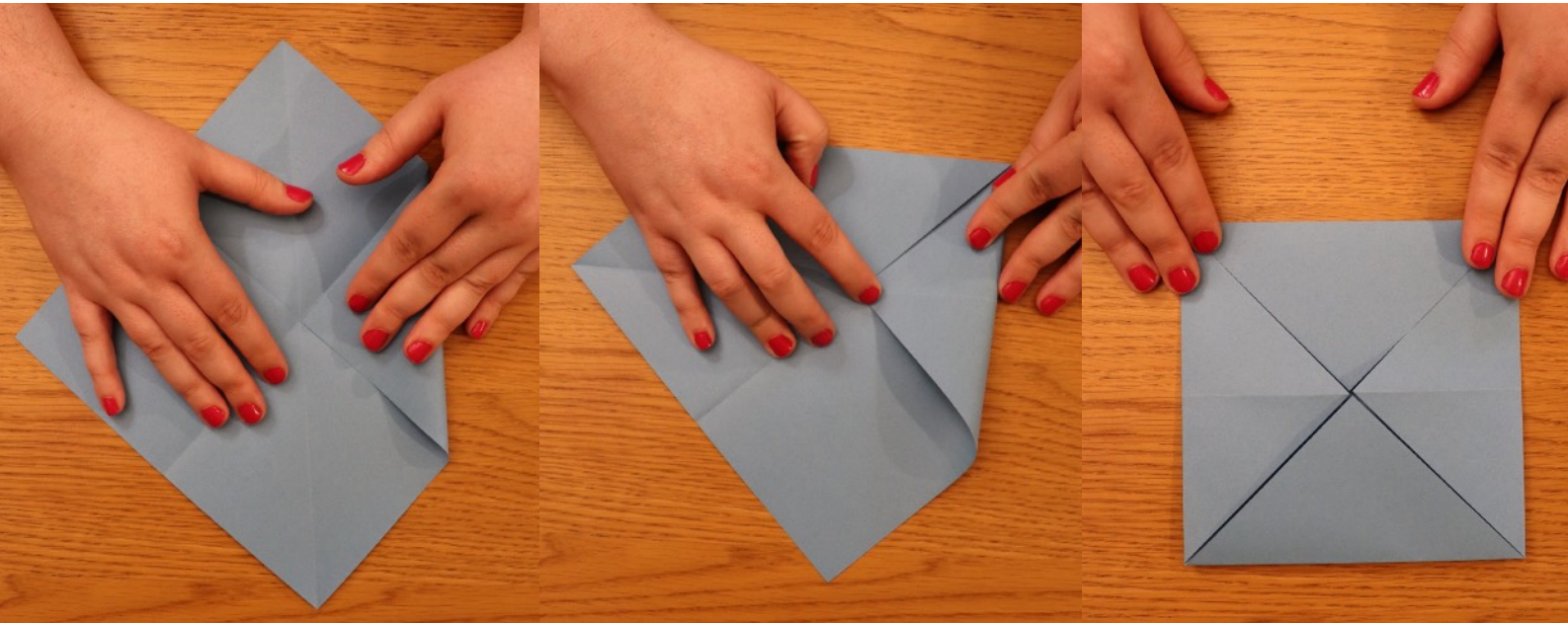

Once you have folded the 4 corners in flip your paper over and repeat the process folding in the corners to the middle. This can feel a bit hard because the paper is thicker but it will fold, just have patience

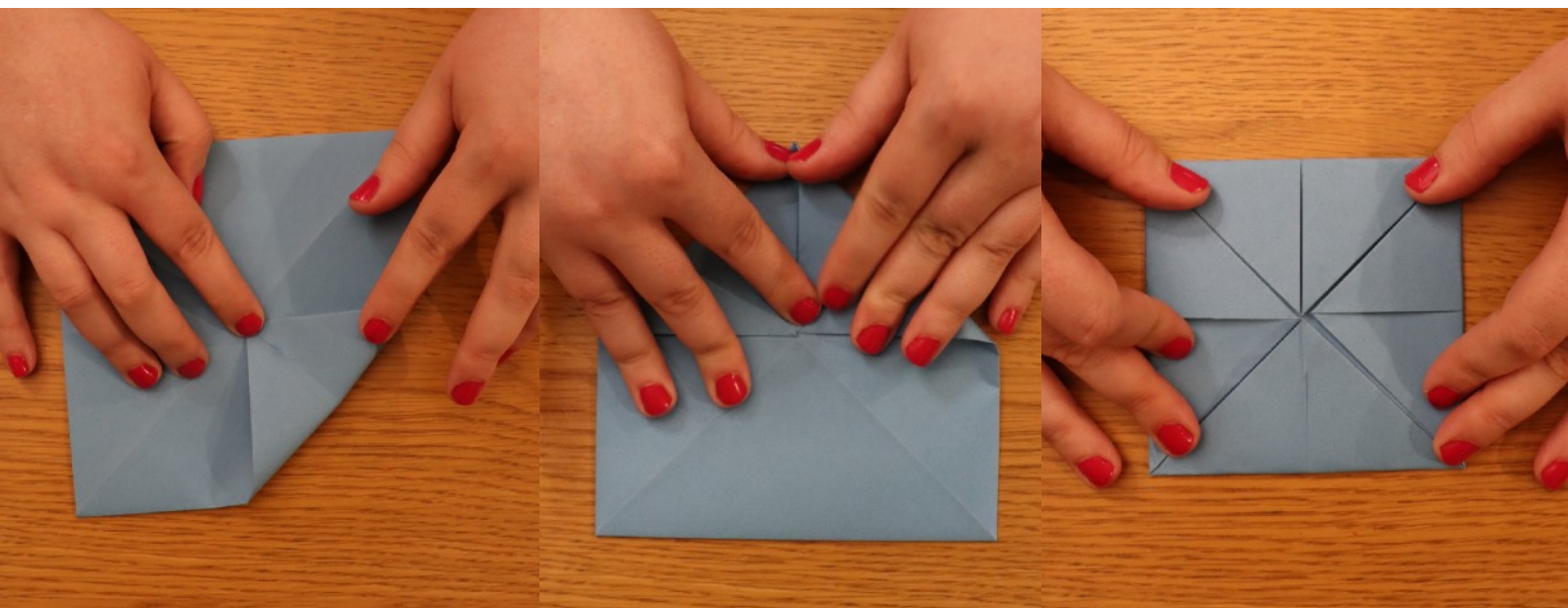

When your paper is looking like above you want to fold it in half to create rectangles again like so, fold it both ways to make the next bit easier

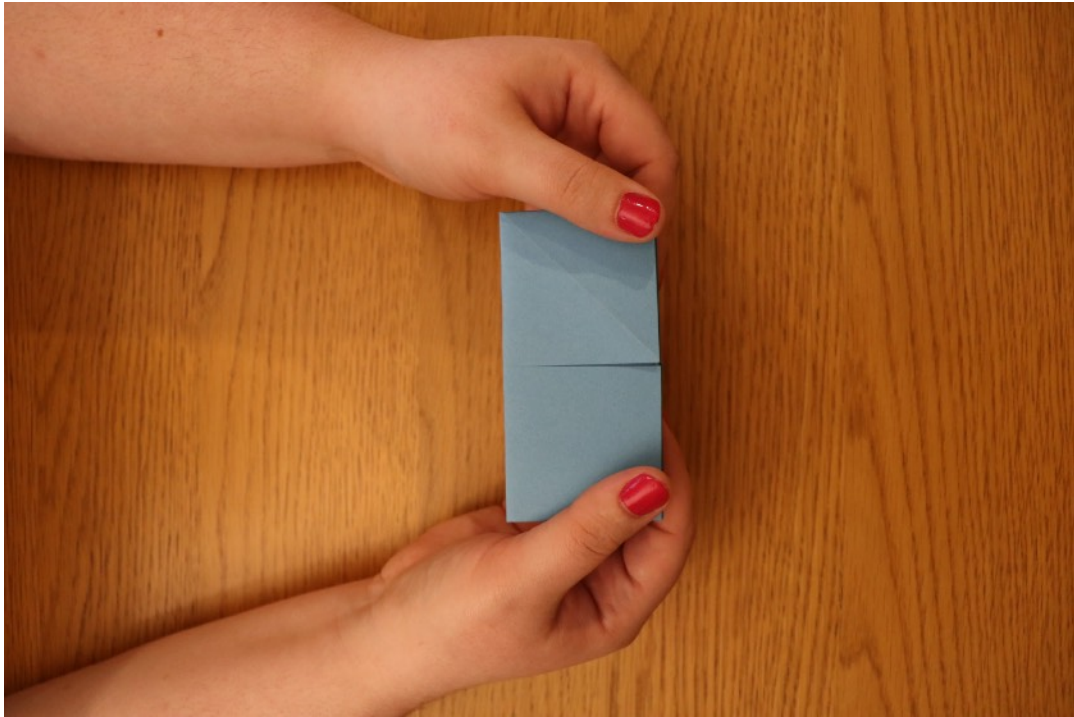

Open it back up so you have the triangles side facing you hold one side firmly in place nearer the middle, and then put one hand underneath. Pop your fingers into the larger squares on the other side to push them up like so, repeat on other side so you can fit both hands under as pictured

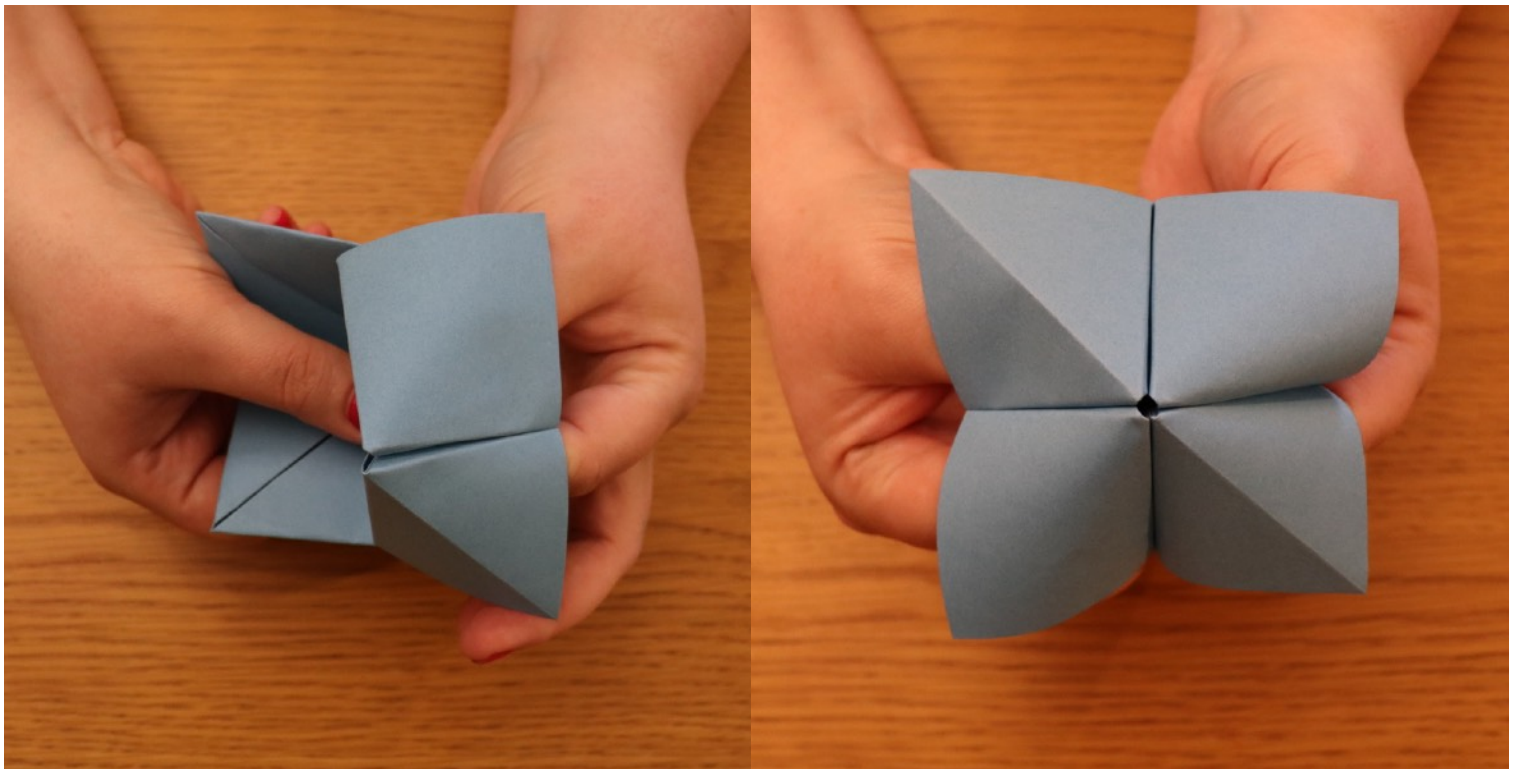

The above instructions cover how to make a chatterbox - a game where you write numbers and draw colours to spell and count out with dares or questions underneath. We are now going to transform it into a creature! We want to create the inside of the mouth so choose what colour you want the tongue to be. Measure the paper against the opened up chatterbox like so - folding it to mark the line to cut then using it to cut a second triangle for the roof of the mouth

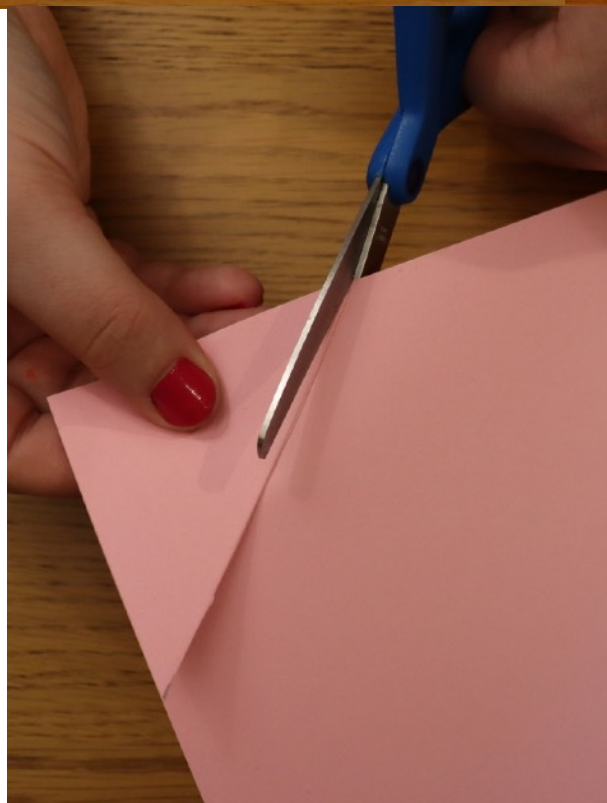
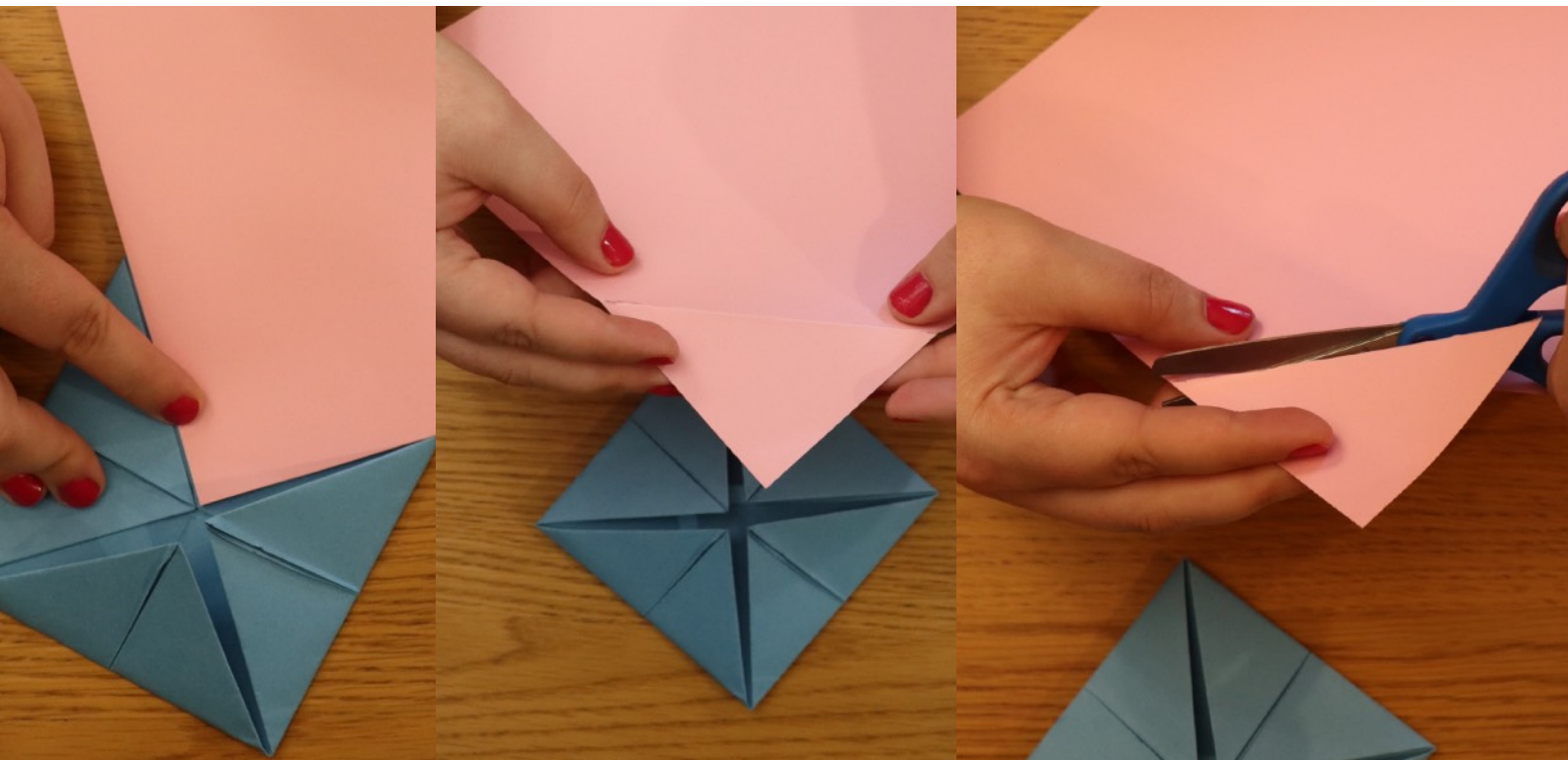

Use one of your triangles as a guide to cut out a dark colour for the roof of mouth to frame the tongue, the one triangle you cut out fold in half and cut a curve like so and then cut it in half along the line you folded

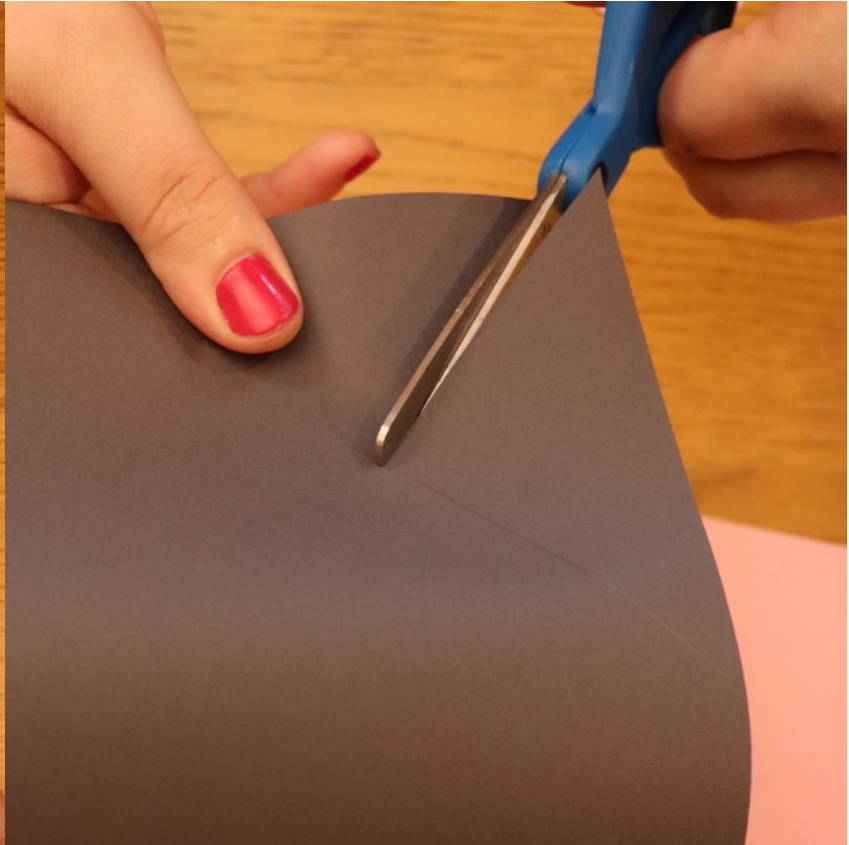
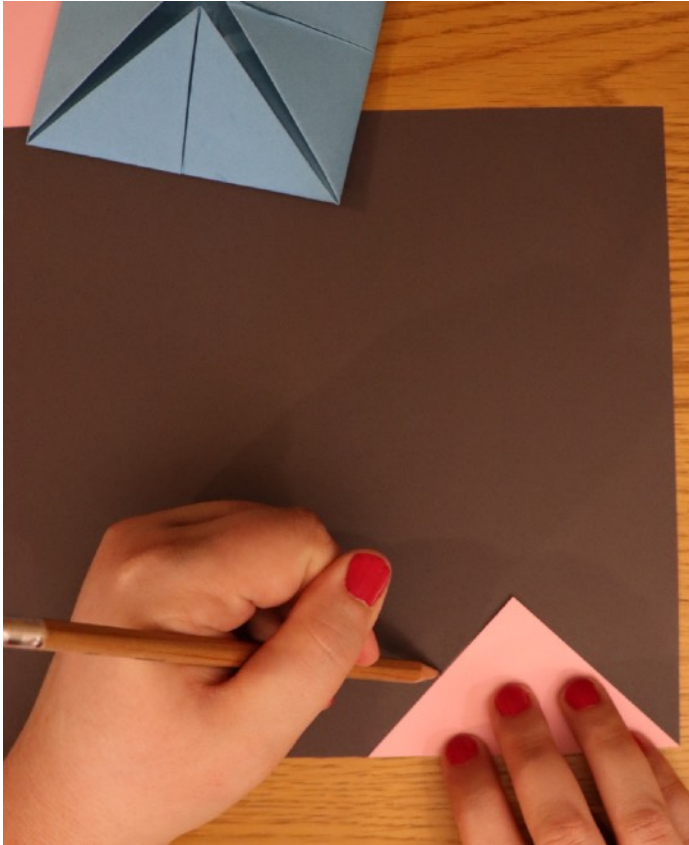

Take the 2 bits of black just cut out and stick them to your 2 pink triangles and then stick your chatterbox like so

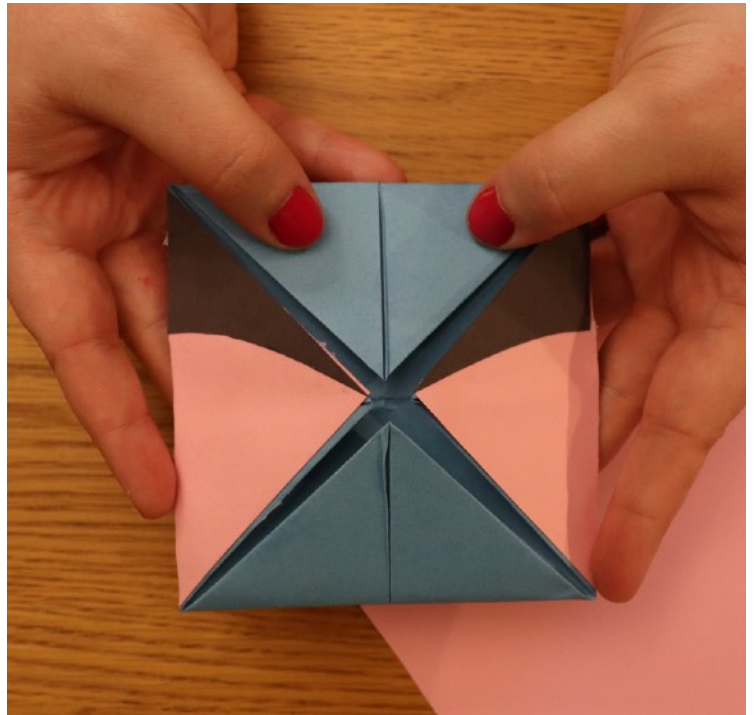
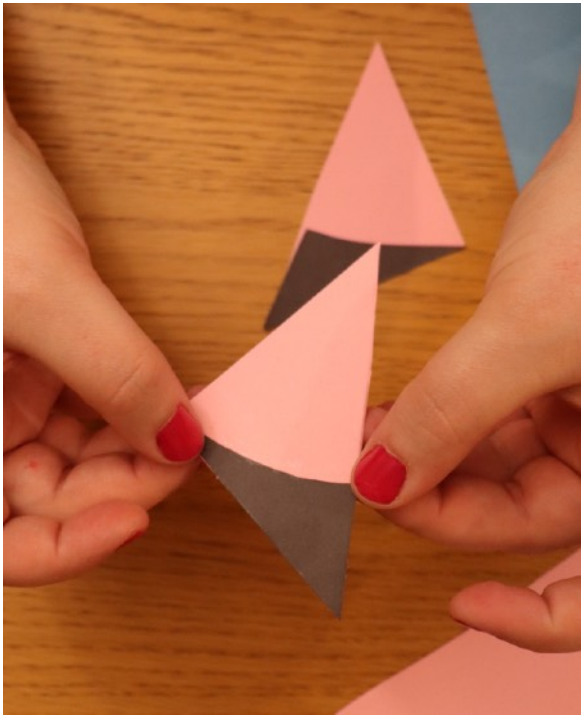

Once they are stuck on put glue over the blue bits on show and then push the large squares back out so you can get your fingers in to hold the sides in place whilst the glue dries - this might take a little while but you want it to keep its shape. So it is an important step!

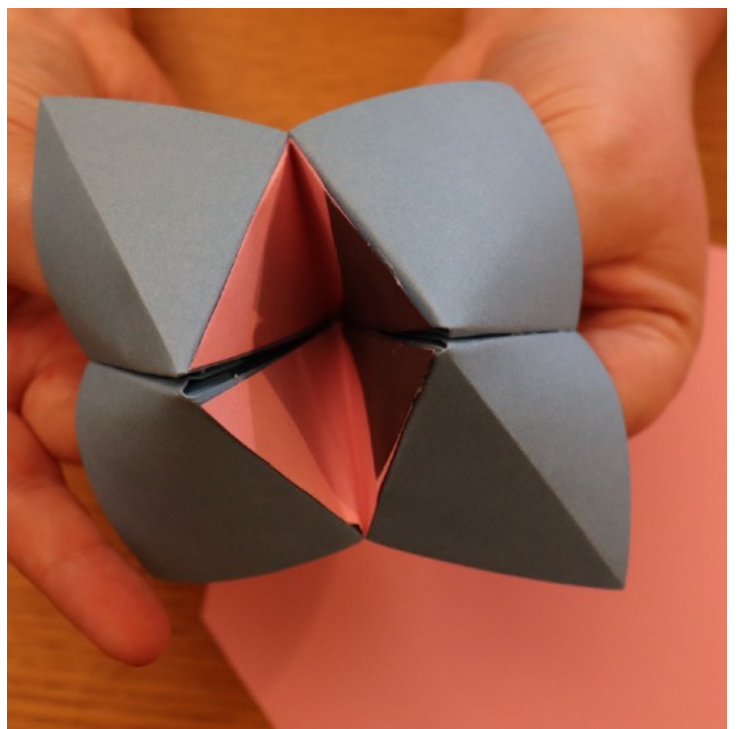
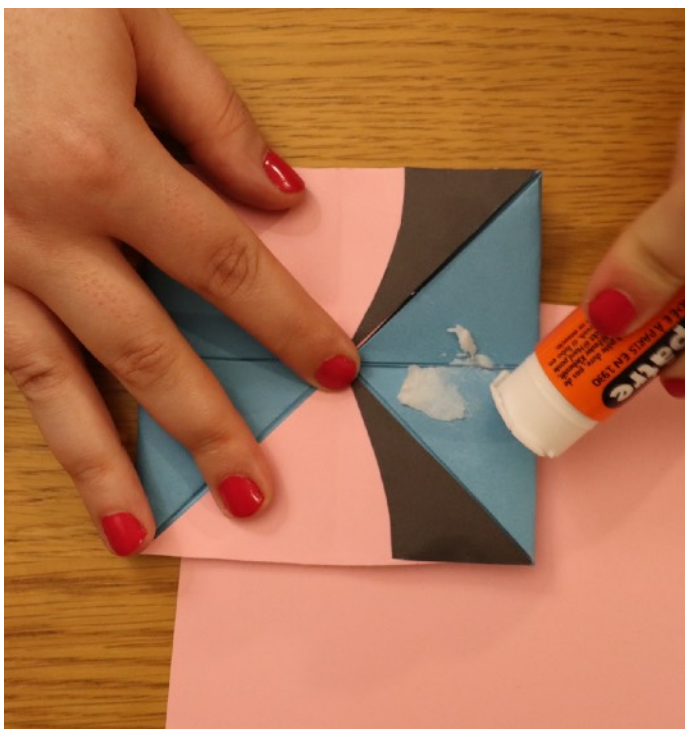

When it is all secure you can trim the corners of the chatterbox to give the face more of a shape, depending on what type of animal you are making. We wanted to make a narwhale so needed it more rounded

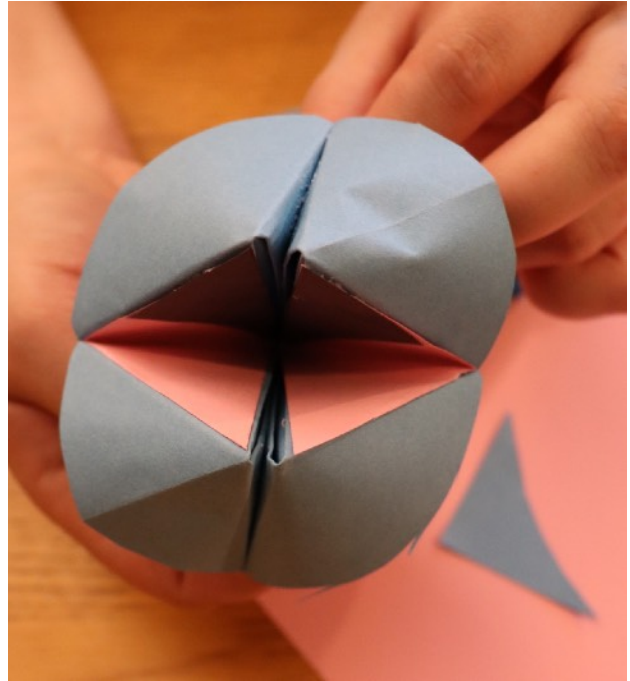
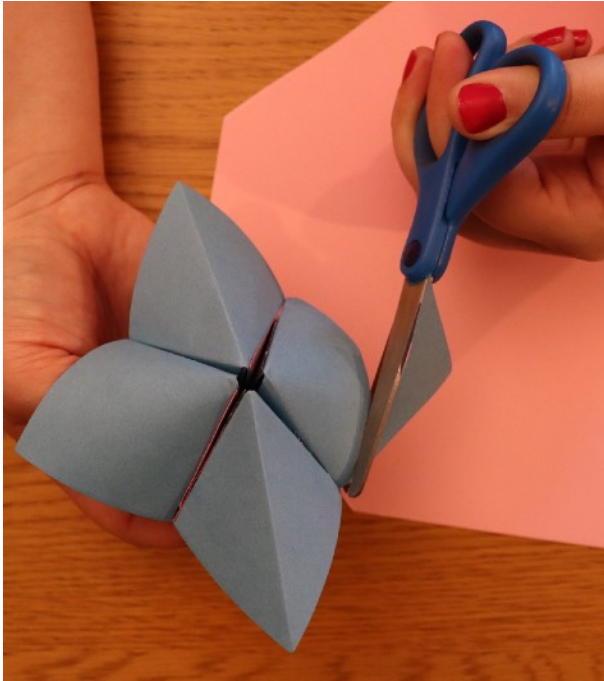

Once you are happy with the shape draw and cut out any embellishments you want to add such as facial features etc

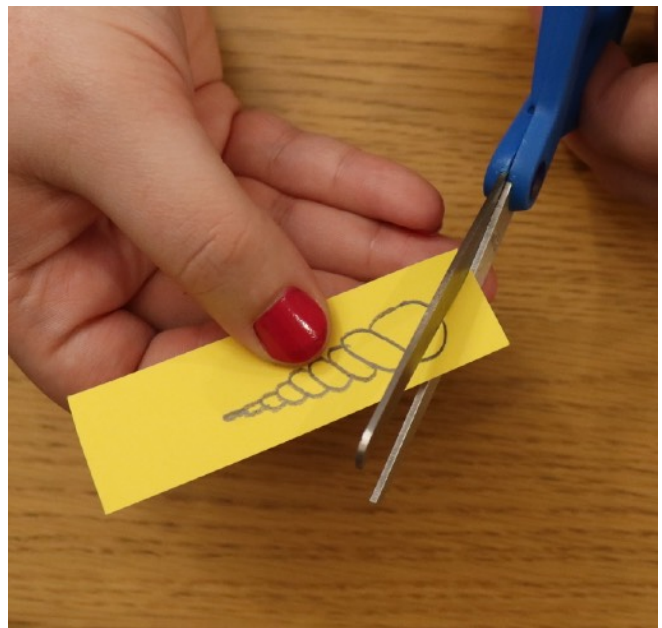
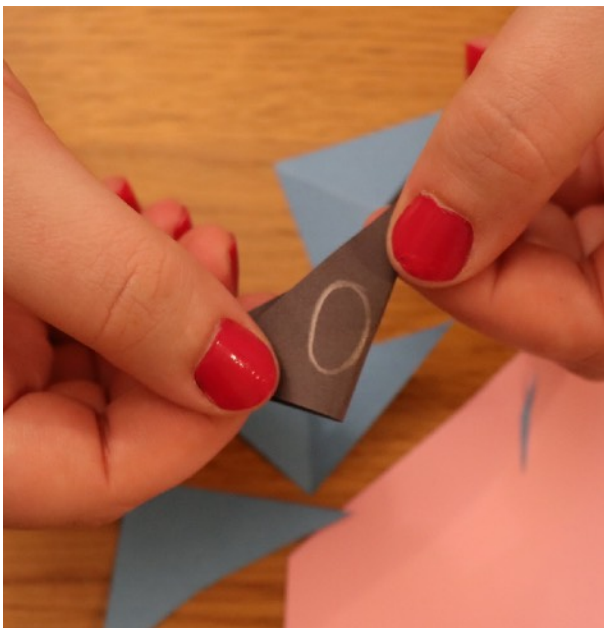

Once you are happy with them then glue them on

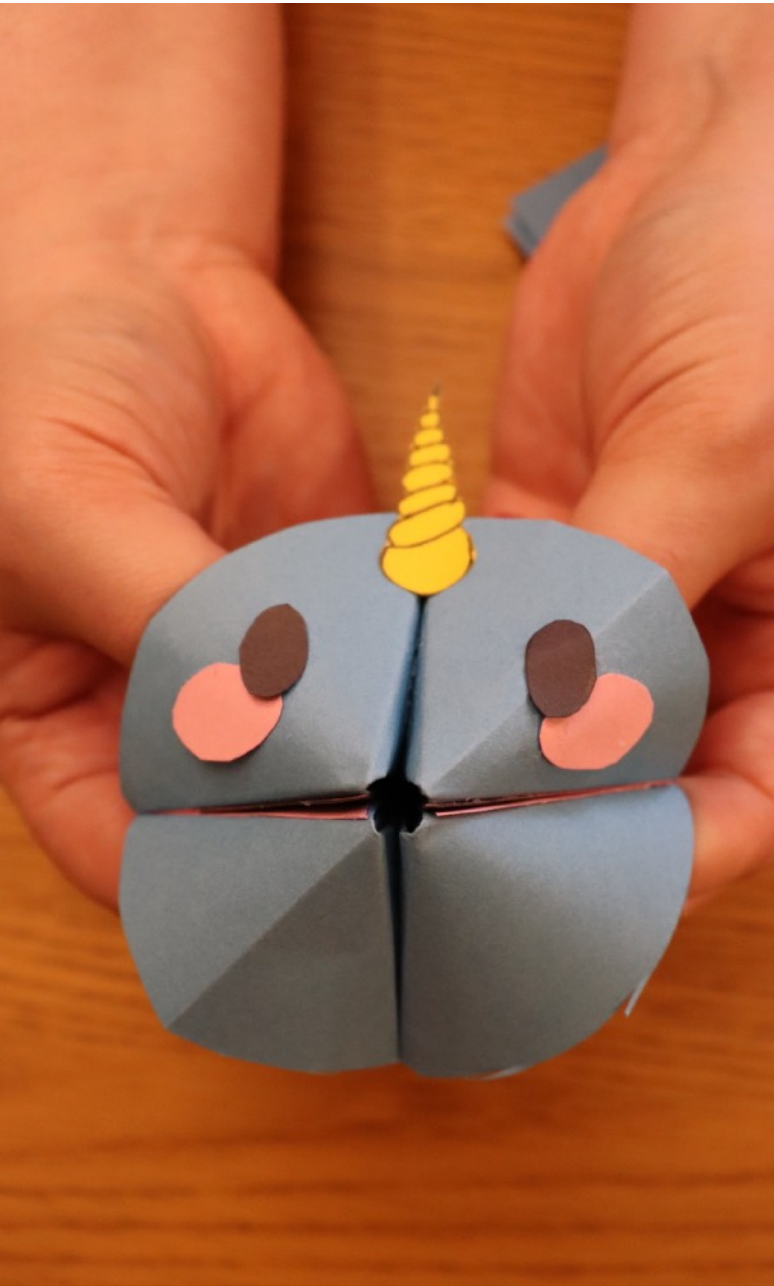

Using a chatterbox as a base means you can almost use your creatures like puppets as you can move the mouth!

There you have it your very own “Chatterbox Creature”!



Here is another we made to inspire you!

